



15 Maple Rise, Tamworth

Offers in Region of £200,000





For Sale With Next Place: A family home with open-plan ground floor, modern kitchen/diner, 3 bedrooms, modern bathroom, decked rear garden & 2 parking spaces. Excellent commuter links & amenities.

Council Tax band: B

Tenure: Freehold

- For Sale With Next Place Property Agents
- Allocated Parking For Two Cars
- Open-Plan Kitchen/Diner
- Well-Maintained Rear Garden
- Modern Bathroom
- Excellent Transport Links
- Video Tour Available
- Council Tax Band B



Living Room

16' 2" x 9' 5" (4.93m x 2.88m)

Kitchen/Diner

9' 7" x 12' 8" (2.91m x 3.85m)

Utility Area

7' 0" x 6' 8" (2.13m x 2.03m)

Bedroom 1

9' 2" x 13' 5" (2.79m x 4.09m)

Bedroom 2

10' 7" x 6' 9" (3.23m x 2.07m)

Bedroom 3

7' 6" x 6' 4" (2.29m x 1.92m)

Landing

Bathroom





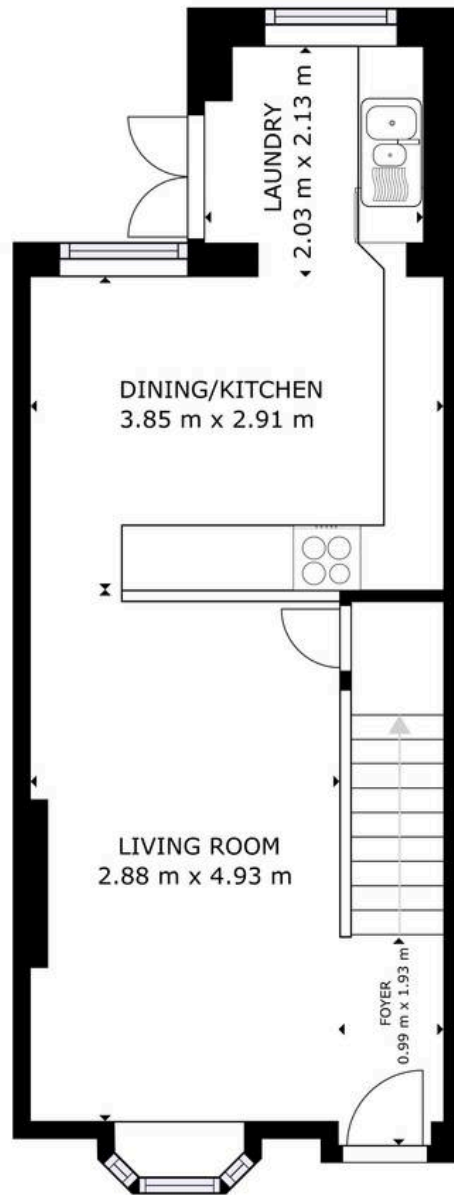

FLOOR 1

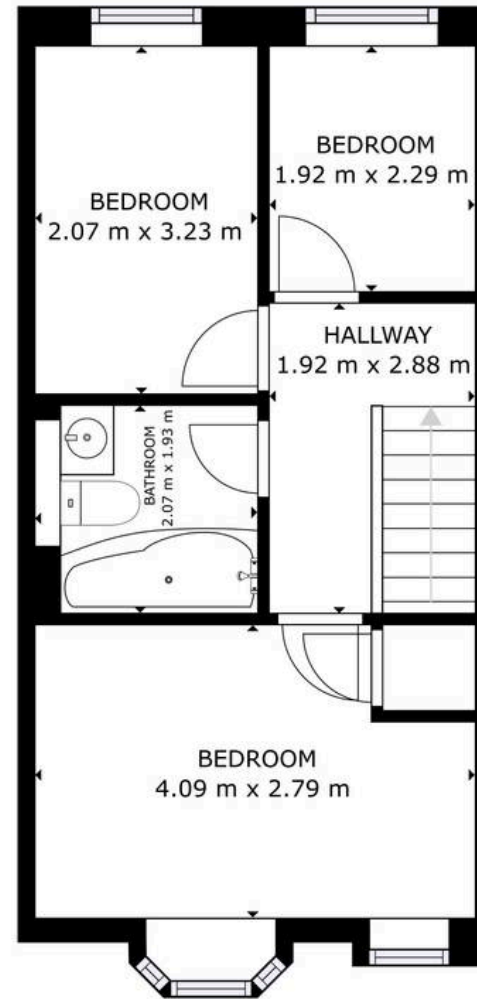

FLOOR 2

GROSS INTERNAL AREA
 FLOOR 1: 36.35 m², FLOOR 2: 34.99 m²
 TOTAL: 71.34 m²
 SIZES AND DIMENSIONS ARE APPROXIMATE, ACTUAL MAY VARY.





Next Place

Next Place Property Agents Ltd, 112 Glascote Road - B77 2AF
01827 50700 • info@next-place.co.uk • www.next-place.co.uk/

