



10 Bardon View Road, Dordon
£260,000





Immaculately presented 3-bed semi-detached property with modern features. Featuring: Lounge/Diner, Modern Kitchen, Utility, 3-Double Bedrooms, Refitted Bathroom, Large Driveway & Landscaped Garden.

Council Tax band: B

Tenure: Freehold

- For Sale With Next Place Property Agents
- 3-Bedroom Semi-Detached Property
- Recently Renovated & Immaculately Presented
- Walking Distance To Local Schools
- Large Lounge/Diner
- Fitted Kitchen With Separate Utility
- Three Double Bedrooms
- Modern Family Bathroom with Separate Shower
- Large Block Paved Driveway
- Council Tax Band B & EPC Rating C



Lounge

22' 5" x 9' 5" (6.82m x 2.88m)

Kitchen

11' 2" x 8' 6" (3.41m x 2.60m)

Utility

7' 5" x 7' 6" (2.25m x 2.29m)

Bedroom 1

11' 8" x 12' 0" (3.55m x 3.67m)

Bedroom 2

13' 1" x 9' 8" (3.99m x 2.95m)

Bedroom 3

10' 6" x 6' 5" (3.19m x 1.96m)

Bathroom





Ground Floor

Approx. 45.3 sq. metres (487.6 sq. feet)

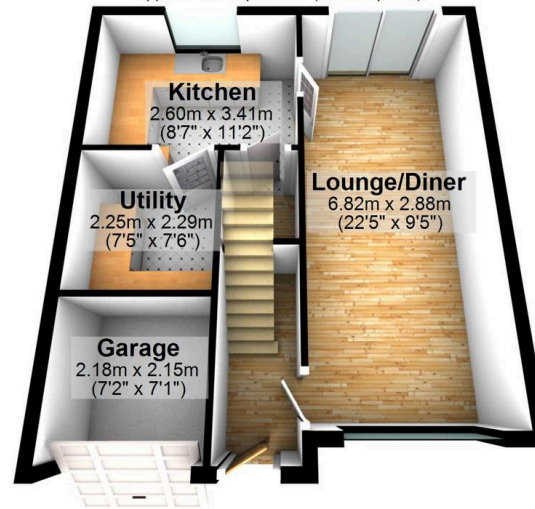

First Floor

Approx. 44.9 sq. metres (483.7 sq. feet)

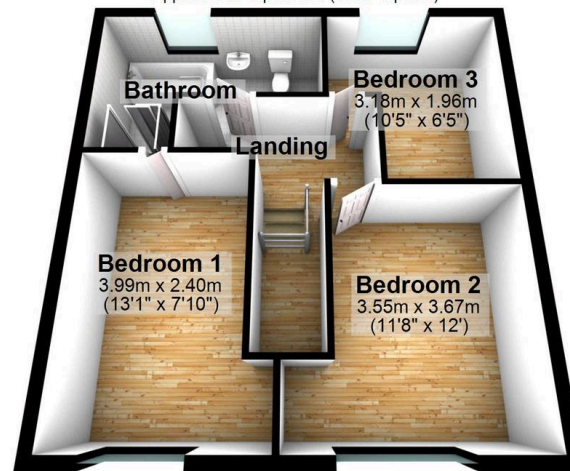

Total area: approx. 90.2 sq. metres (971.4 sq. feet)





Next Place

Next Place Property Agents Ltd, 112 Glascote Road - B77 2AF
01827 50700 • info@next-place.co.uk • www.next-place.co.uk/

